

MP-500-13-CM

246 lb. WLL

CEILING PLATE FOR 1/2-13 THREADED ROD

CEILING ATTACHMENT



CEILING MOUNT

The MP-500-13-CM suspends objects and assemblies from ceiling and structures. This ceiling mount assembly accepts 1/2-13 threaded rods in length up to 48" for unsupported objects. For supported objects up to 144".

Use this mount to create overhead grids using channel strut or single point mounts for objects weighing up to 246 lbs



KEY FEATURES:

- ▶ For overhead audio and video applications
- ▶ Adapts to 1/2-13 load-rated B7 threaded rod.

OPTIONAL ACCESSORIES:

- ▶ See Threaded Rod Datasheet

SPECIFICATIONS:

Material: Structural Steel

Finish: Powder Coat

Color: Black

Design Factor: 7:1

WLL: 246 / 111.5 Kg.

Shipping Weight: 5 lbs / 2.3 Kg.

PACKAGE CONTENTS:

1 pc Ceiling Mount w/1/2-13 thread

1 pc Set Screw, 1/4-20

DIMENSIONS:

MP-500-13-CM
Ceiling Plate

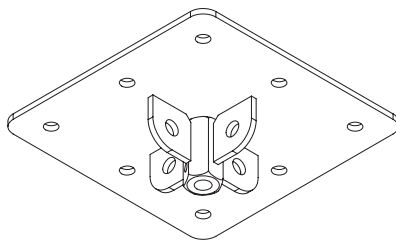

Top View

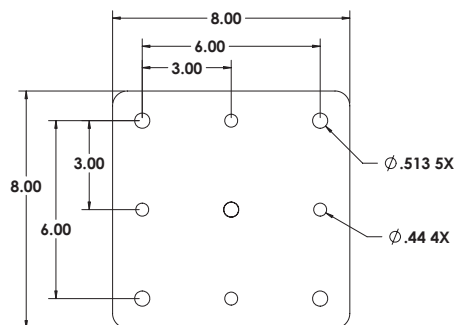

Side View

