

Swiveling Cross Arm Kit

GridLink® Cross Arm Swivel Kit

The GridLink Cross Arm kit is part of the GridLink Rigging Beam System that provides up to 360° of horizontal rotation for loudspeakers and other objects from Rigging Beams and overhead grids.

The Cross Arm Kit is ideal for applications where a simple pan rotation is needed to aim a loudspeaker horizontally.

Tilt control is achievable through the addition of a standard fixed width U-Bracket or a Tilt Cable Kit.

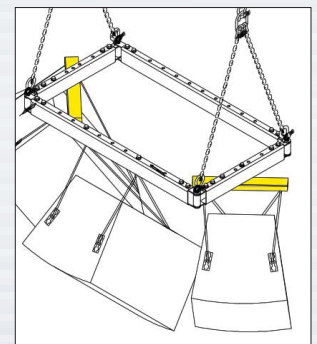

Cross Arms in yellow

STANDARD FEATURES:

- ▶ Provides up to 360° of horizontal aiming
- ▶ Adapts to standard U-Brackets and Tilt Cable Kits
- ▶ Connects directly to GridLink Rigging Beams

OPTIONAL ACCESSORIES:

- ▶ See Rigging Beam datasheets
- ▶ See Tilt Cable Kit datasheets
- ▶ See U-Bracket datasheet

SPECIFICATIONS:

Material: Alloy steel tube
Finish: Powder coat paint
Color: Textured black and off-white
Working Load: 300 lb / 136 kg
Safety Factor: 7:1 ratio
Product Weight: 9.4 lb / 4.2 Kg

PACKAGE CONTENTS:

- 1 pc** Cross Arm
- 2 pcs** End Caps
- 2 pcs** 5/16" Eye Bolts
- 1 pc** Hardware Kit



DIMENSIONS:

Bottom View

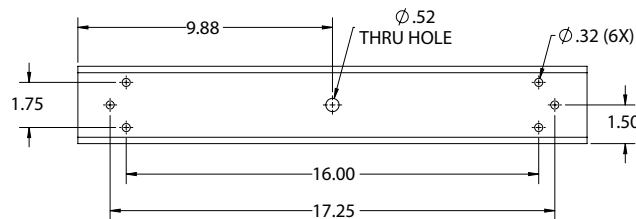

Side View

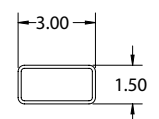
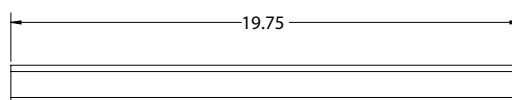

End View

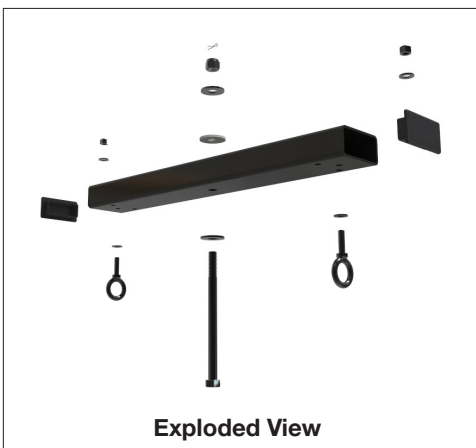

Exploded View

ALWAYS INSTALL SAFETY CABLES

WARNING: Mounting and/or suspension of equipment requires experienced professionals. Improperly installed equipment can result in property damage, personal injury and/or liability to the installing contractor.